



Cathay Street, London, SE16 4TS

Please note: Single Occupancy or Couples Only - A naturally bright two bedroom apartment by the River Thames in one of the most sought-after North Bermondsey / Rotherhithe locations. The property boasts a spacious living room leading into the private balcony enjoying pleasant greenery and water views, two double bedrooms one of which is perfect for a home office / guest room, the fully equipped separate kitchen, and the well kept bathroom. The apartment is located moments Bermondsey Underground Station for the Jubilee Line and Rotherhithe Overground Stations as well as a plethora of local cafes, pubs, grocery shops and restaurants.

Council Tax Band: B

£2,000 Per month

- Riverside Development
- Private Balcony
- Naturally Bright
- Spacious Living Room
- Separate Kitchen
- Plenty Of Storage Space
- Moments From Underground and Overground Stations

Alex & Matteo
ESTATE AGENTS

Cathay House

Approx. Gross Internal Area 689 Sq Ft - 64.01 Sq M

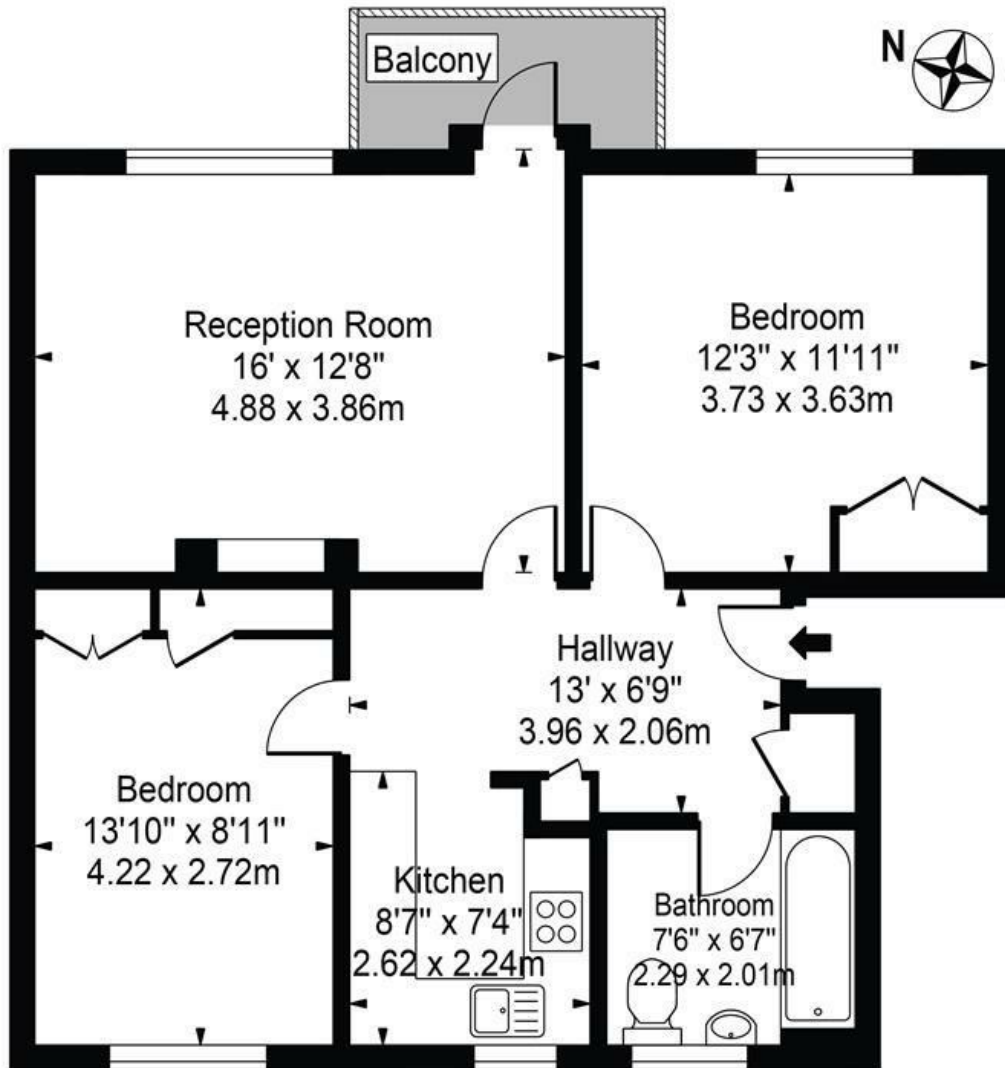

First Floor

For Illustration Purposes Only - Not To Scale

This floor plan should be used as a general outline for guidance only and does not constitute in whole or in part an offer or contract. Any intending purchaser or lessee should satisfy themselves by inspection, searches, enquiries and full survey as to the correctness of each statement. Any areas, measurements or distances quoted are approximate and should not be used to value a property or be the basis of any sale or let.

Energy Efficiency Rating		
	Current	Potential
Very energy efficient - lower running costs		
(92 plus) A		
(81-91) B		
(69-80) C	71	80
(55-68) D		
(39-54) E		
(21-38) F		
(1-20) G		
Not energy efficient - higher running costs		
England & Wales		
EU Directive 2002/91/EC		